

Model: NEMA14 Stepper motor-SM35HM(0.9 degree)

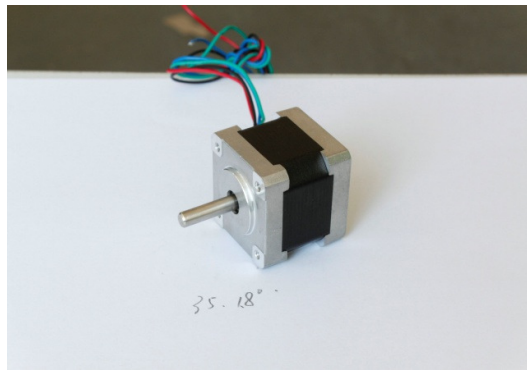

General Specification:

Step Accuracy	----- ±5%
Resistance Accuracy	----- ±10%
Inductance Accuracy	----- ±20%
Temperature Rise	----- 80°C MAX.
Ambient Temperature Range	----- -20°C~ +50°C
Storage Temperature Range	----- -30°C~ +60°C
Insulation Resistance	----- 100M Ω MIN. 500V DC
Dielectric Strength	----- 500V AC 1min
Radial Play	----- 0.02mm MAX. (450g Load)
End Play	----- 0.08mm MAX. (450g Load)
Max. radial force	----- 28N
Max. axial force	----- 10N

Electrical Specification:

Series Model	Motor Length (mm)	Rated Current (A)	Phase Resistance (ohm)	Phase Inductance (mH)	Holding Torque (N.cm Min)	Detent Torque (N.cm Max)	Rotor Inertia (g.cm ²)	Lead Wire (No.)	Motor Weight (g)
SM35HM20-0404	20	0.4	24	18	5	0.2	10	4	120
SM35HM28-0804	28	0.8	4.5	4.2	9	0.3	12	4	130
SM35HM28-0504	28	0.55	10	9.5	9	0.3	12	4	130
SM35HM28-0406	28	0.4	30	12	8	0.3	12	6	130
SM35HM34-0804	34	0.8	6	10	14	0.6	18	4	190
SM35HM34-0504	34	0.55	12	19	14	0.6	18	4	190
SM35HM34-0404	34	0.40	28	42	14	0.6	18	4	190
SM35HM34-0406	34	0.4	30	18	10	0.6	18	6	190

***Note:** We can also manufacture products according to customer's requirements.

**Dimensions:
(Unit=mm)**

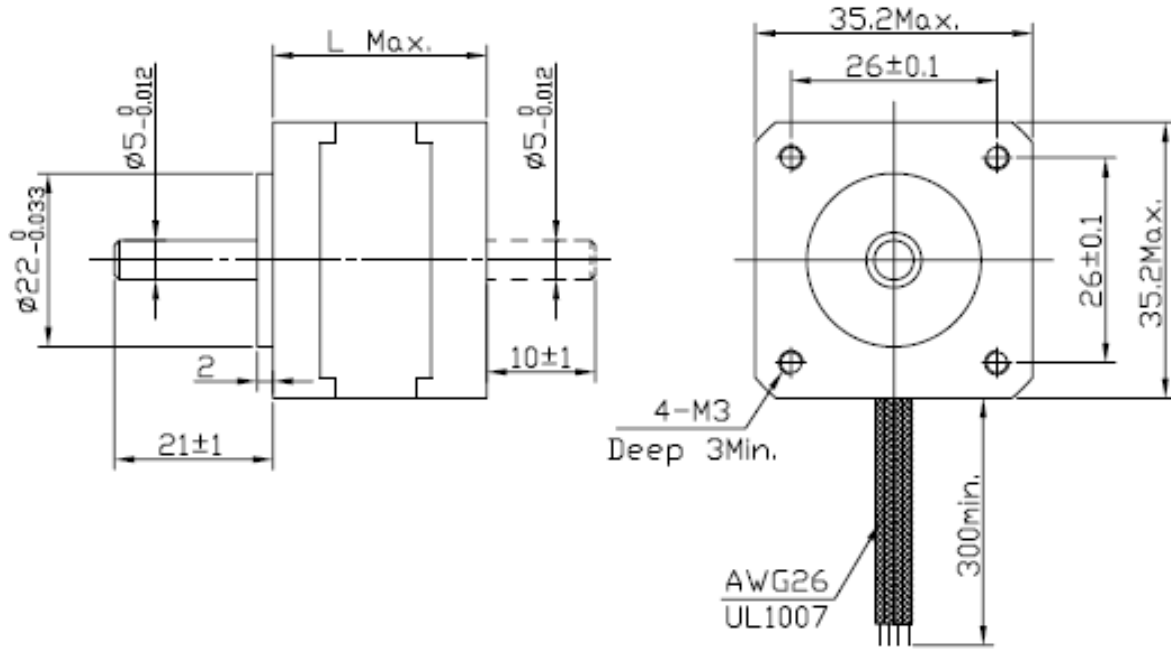

Wiring Diagram:

6 LEADS

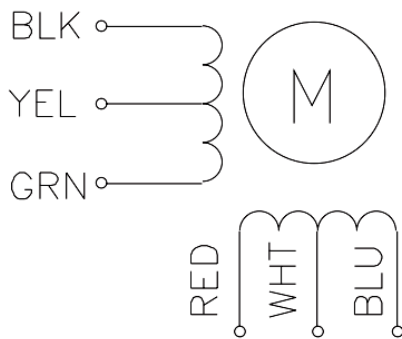

4 LEADS

