

130 SY Series AC servo motor



Temperature	0°C -55°C
Number of pole pairs	4
Incremental encoder line	2500/5000PPR
Absolute encoder	17bit
Humidity is less than	90%
Insulation class	B
Safety Class	IP65
Insulation and voltage resistance	AC 1500V, 1 Minute
Insulation resistance	DC500V, 10M above
Vibration	Under 2.5G
Altitude	Under 1000m
Work system	Continuous
Installation Method	Flange installation

Specifications

Motor Model	130SY-M04025	130SY-M05025	130SY-M06025	130SY-M07720	130SY-M07725	130SY-M10010	130SY-M10015	130SY-M10025	130SY-M15015	130SY-M15025	130SY-M20015
Rated Power(Kw)	1.0	1.3	1.5	1.6	2.0	1.0	1.5	2.6	2.3	3.8	3
Rated Current(A)	4.0	5.0	6.0	5.5	7.5	4.5	6	10	9.5	17	15
Rated Torque(N.m)	4	5	6	7.7	7.7	10	10	10	15	15	20
Max Torque(N.m)	12	15	18	22	22	25	25	25	30	30	35
Rated Speed(rpm)	2500	2500	2500	2000	2500	1000	1500	2500	1500	2500	1500
Max Speed(rpm)	2800	2800	2800	2500	2800	1500	1800	2800	1800	2800	1800
Rotor Inertia(Kg.m ²)	0.82x10 ⁻³	1.20x10 ⁻³	1.26x10 ⁻³	1.53x10 ⁻³	1.53x10 ⁻³	1.94x10 ⁻³	1.94x10 ⁻³	1.94x10 ⁻³	1.94x10 ⁻³	2.77x10 ⁻³	3.67x10 ⁻³
Motor Weight (Kg)	6.5	7.0	7.5	8.5	8.5	10	10	10	12	12	15

Specifications

Motor Model	130SY-M05020-S	130SY-M07220-S	130SY-M10020-S
Rated Power(Kw)	1.0	1.5	2
Rated Current(A)	5	7.5	10
Rated Torque(N.m)	4.77	7.16	9.55
Max Torque(N.m)	14.31	21.48	28.65
Rated Speed(rpm)	2000	2000	2000
Max Speed(rpm)	3000	3000	3000
Rotor Inertia(Kg.m ²)	1.08x10 ⁻³	1.54x10 ⁻³	1.98x10 ⁻³
Motor Weight (Kg)	7.8	8.9	10.2

Installation size chart unit=mm

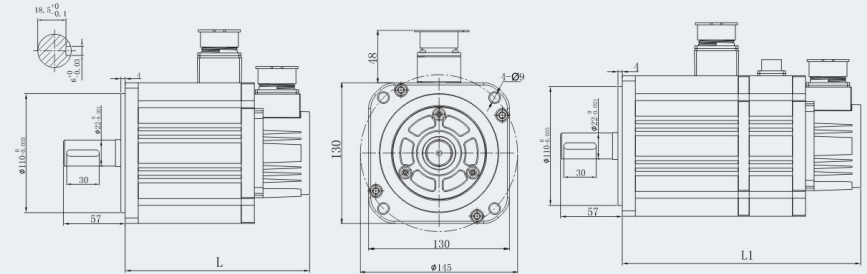

Note:
*All above is the standard installation dimension, can be changed according to the customers' requirements
*Not hit the shaft, or the encoder in the other end would be damaged.

130SY-M Motor length

Specifications	4N.m	5N.m	6N.m	7.7N.m	10N.m	15N.m	20N.m
L	169	175	182	195	212	234	269
L1	219	225	232	245	262	299	334

130SY-M-S Motor length

Specifications	4.77N.m	7.16N.m	9.55N.m
L	180	205	230
L1	230	255	280

power line

130SY-M series motor's winding by the 4-core connector, for the corresponding please check the following form 1

The encoder connection table

Winding wire	U	V	W	PE	Brake Wiring	Brake	Brake
Socket Number	2	3	4	1	Socket number	1	2
					Brake voltage	DC24V	

Note: Brake voltage is DC 24V (Non polar requirement)

Encoder wiring table

Signal definition	5V	OV	A+	B+	Z+	A-	B-	Z-	U+	V+	W+	U-	V-	W-	PE
Socket Number	2	3	4	5	6	7	8	9	10	11	12	13	14	15	1